

QWCA-187-7F-R

WR-187 to 7/16 DIN female, Right angle

Features:
* Low VSWR

Applications:
* Wireless
* Transmitter
* Laboratory Test
* Radar

Electrical

Frequency: 3.95–5.85GHz
VSWR: 1.2 max.
Impedance: 50Ω

How To Order

QWCA-187-7F-R

Customization is available upon request.

Mechanical

Length: 60mm
2.362in
RF Connectors: 7/16 DIN Female
Interface: WR-187
Flange: FDP48
Material: Aluminium

Outline Drawings

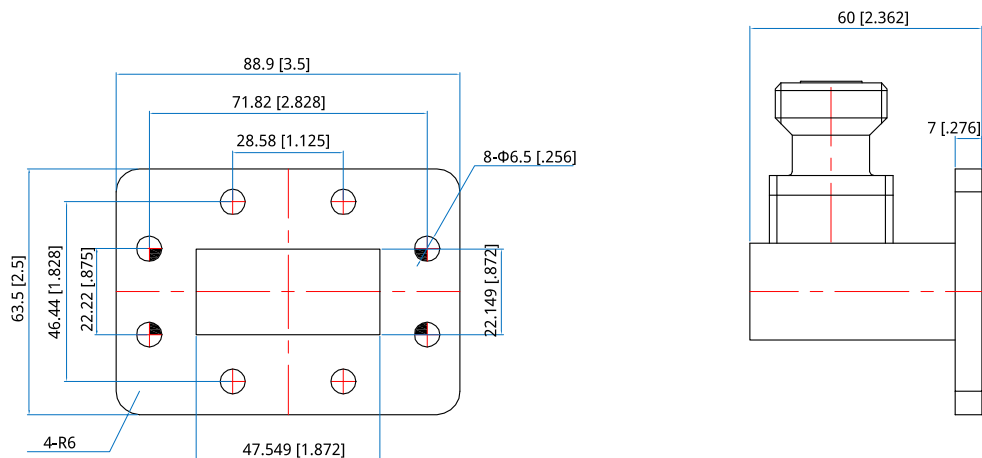

Unit: mm [in]

Tolerance: $\pm 0.2\text{mm}$ [$\pm 0.008\text{in}$]