

QCT2605 DC~26.5GHz, 5W

Features:
* Low VSWR
* Broadband

Applications:
* Transmitters
* Antennas
* Laboratory Test
* Impedance Matching

Electrical

Frequency Range: DC~26.5GHz
Average Power^{*1}: 5W@25°C max.
Impedance: 50Ω
VSWR: 1.25 max. (SMA)
1.2 max. (3.5mm)

[1] Derated linearly to 0.25W@120°C.

Mechanical

Connectors: SMA, 3.5mm
Housing: Aluminum
Outer Conductor: Gold plated brass or passivated stainless steel
Male Inner Conductor: Gold plated brass
Female Inner Conductor: Gold plated beryllium copper

Environmental

Temperature: -55~+85°C

Outline Drawings

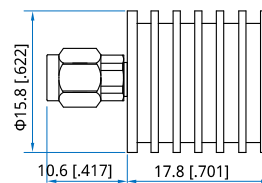

Outline A

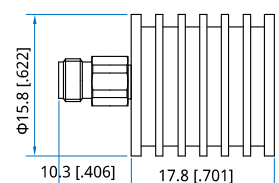

Outline B

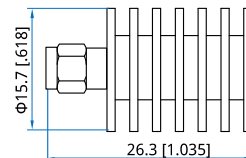

Outline C

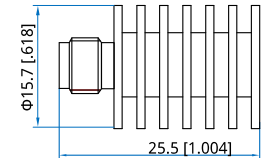

Outline D

Unit: mm [in]

Tolerance: ±0.2mm [±0.008in]

How To Order

QCT2605-X-Y

X: Frequency in GHz

Y: Connector type

Connector naming rules:

S - SMA male (Outline A)

SF - SMA female (Outline B)

3 - 3.5mm male (Outline C)

3F - 3.5mm female (Outline D)

Examples:

To order a termination, DC~26.5GHz, SMA male, specify QCT2605-26.5-S.

Customization is available upon request.